

EXHIBIT G

PROJECT BOUNDARY MAP

**NORTHERN ILLINOIS HYDROPOWER, LLC.  
BRANDON ROAD HYDROPOWER PROJECT  
(FERC NO. 12717)**

**EXHIBIT G  
PROJECT BOUNDARY MAPS**



Line	Bearing	Distance (m)
1	S17° 9' 8.6"E	73.10
2	S71° 17' 17.9"W	28.22
3	N18° 0' 22.3"W	45.93
4	N17° 51' 25.9"W	15.16
5	S71° 16' 6.2"W	66.94
6	N17° 26' 59.6"W	8.90
7	S70° 36' 39.6"W	20.64
8	S20° 45' 37.8"E	15.10
9	S70° 31' 25.7"W	15.24
10	N19° 33' 12.2"W	15.11
11	S70° 36' 39.6"W	0.52
12	N46° 9' 16.9"W	60.58
13	S49° 12' 37.1"W	291.21
14	S49° 12' 36.7"W	0.23
15	N18° 29' 34.1"W	251.67
16	S20° 1' 59.2"W	177.12
17	S68° 24' 23.4"W	650.38
18	S67° 1' 19.6"W	0.01
19	S65° 38' 15.7"W	387.81
20	S67° 25' 8"W	0.01
21	S69° 12' 0.4"W	571.65
22	S2° 27' 34.2"W	63.80
23	S44° 58' 55.2"W	156.08
24	N45° 1' 4.8"W	0.31
25	N44° 58' 55.2"E	155.96
26	N2° 27' 34.2"E	63.88
27	N69° 12' 0.4"E	571.84
28	N67° 25' 8"E	0.01
29	N65° 38' 15.7"E	387.80
30	N67° 1' 19.6"E	0.01
31	N68° 24' 23.4"E	650.25
32	N20° 1' 59.2"E	177.86
33	S18° 29' 34.1"E	252.09
34	N49° 12' 37.1"E	291.26
35	S46° 9' 16.9"E	60.67
36	N70° 36' 39.6"E	35.90
37	N17° 26' 59.6"W	1.23
38	N70° 38' 27.6"E	67.64
39	N15° 50' 35.2"W	33.17
40	N2° 29' 22.6"W	29.78
41	N24° 32' 20.8"E	29.76
42	N80° 32' 33.4"E	24.19
43	S0° 35' 48.5"E	82.79

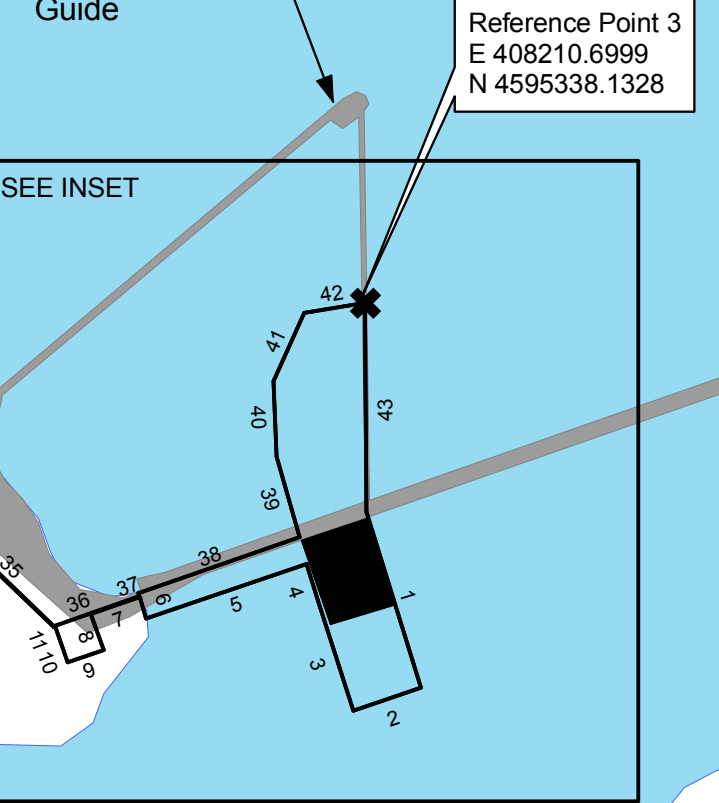
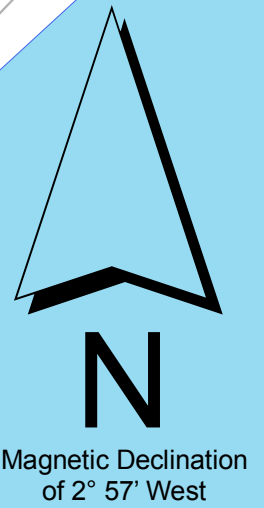
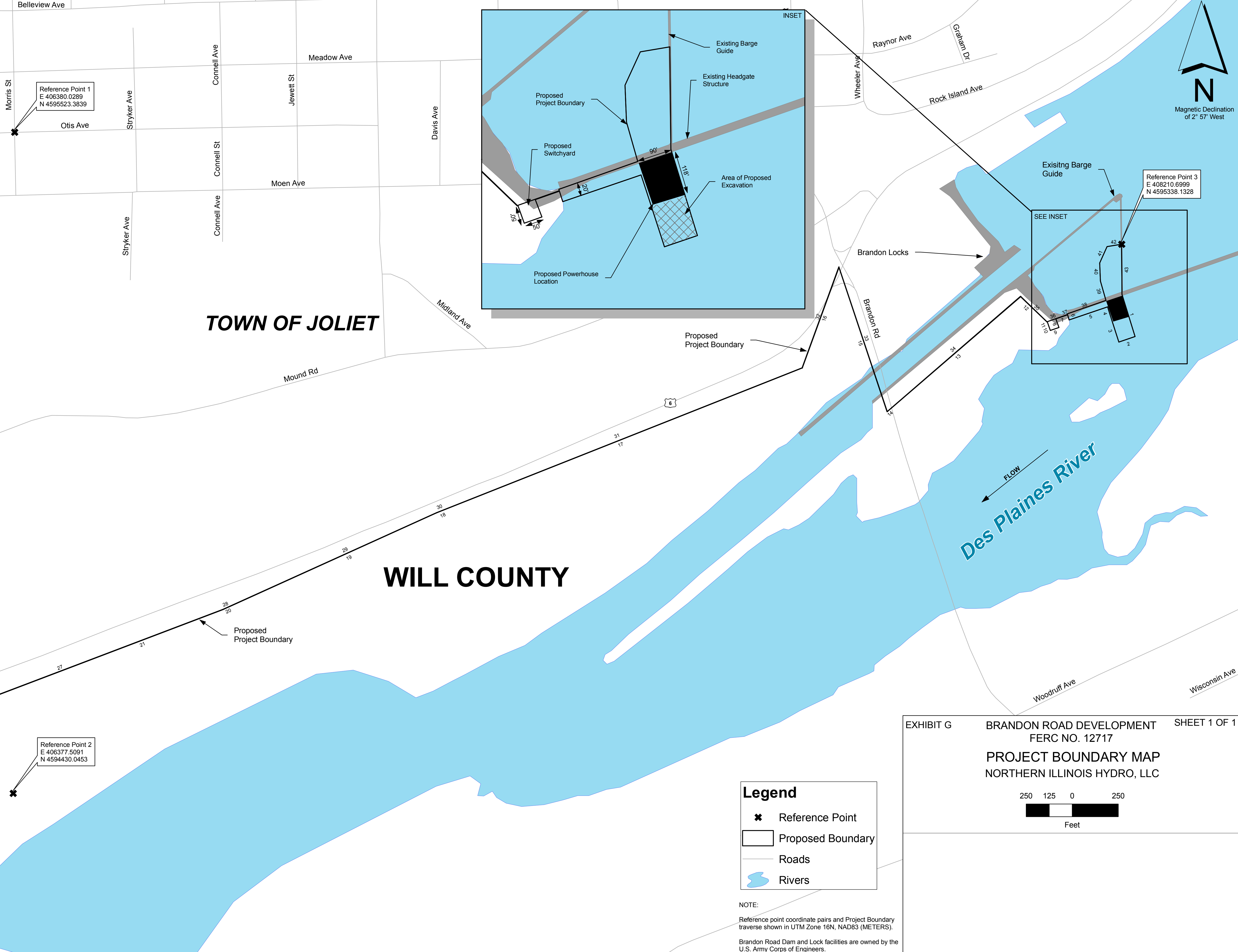

EXHIBIT G BRANDON ROAD DEVELOPMENT SHEET 1 OF 1  
 FERC NO. 12717  
 PROJECT BOUNDARY MAP  
 NORTHERN ILLINOIS HYDRO, LLC

250 125 0 250  
 Feet

**Legend**

- ✘ Reference Point
- ▭ Proposed Boundary
- Roads
- 🌊 Rivers

NOTE:  
 Reference point coordinate pairs and Project Boundary traverse shown in UTM Zone 16N, NAD83 (METERS).  
 Brandon Road Dam and Lock facilities are owned by the U.S. Army Corps of Engineers.