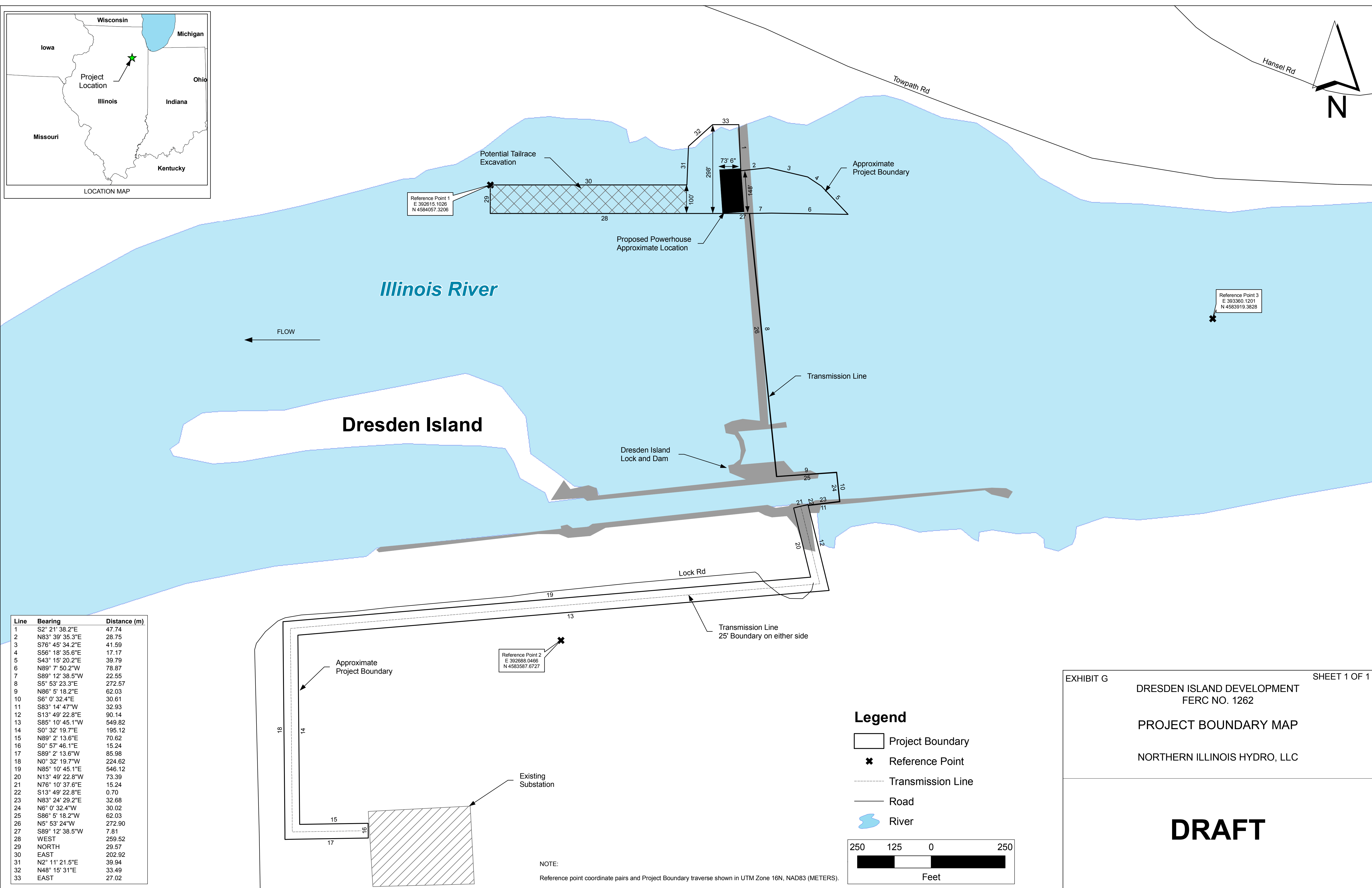
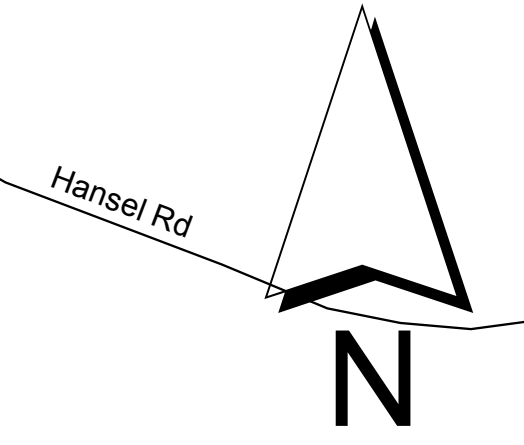

EXHIBIT G

PROJECT BOUNDARY MAP



Line	Bearing	Distance (m)
1	S2° 21' 38.2"E	47.74
2	N83° 39' 35.3"E	28.75
3	S76° 45' 34.2"E	41.59
4	S56° 18' 35.6"E	17.17
5	S43° 15' 20.2"E	39.79
6	N89° 7' 50.2"W	78.87
7	S89° 12' 38.5"W	22.55
8	S5° 53' 23.3"E	272.57
9	N86° 5' 18.2"E	62.03
10	S6° 0' 32.4"E	30.61
11	S83° 14' 47"W	32.93
12	S13° 49' 22.8"E	90.14
13	S85° 10' 45.1"W	549.82
14	S0° 32' 19.7"E	195.12
15	N89° 2' 13.6"E	70.62
16	S0° 57' 46.1"E	15.24
17	S89° 2' 13.6"W	85.98
18	N0° 32' 19.7"W	224.62
19	N85° 10' 45.1"E	546.12
20	N13° 49' 22.8"W	73.39
21	N76° 10' 37.6"E	15.24
22	S13° 49' 22.8"E	0.70
23	N83° 24' 29.2"E	32.68
24	N6° 0' 32.4"W	30.02
25	S86° 5' 18.2"W	62.03
26	N5° 53' 24"W	272.90
27	S89° 12' 38.5"W	7.81
28	WEST	259.52
29	NORTH	29.57
30	EAST	202.92
31	N2° 11' 21.5"E	39.94
32	N48° 15' 31"E	33.49
33	EAST	27.02

Legend

- Project Boundary
- Reference Point
- Transmission Line
- Road
- River

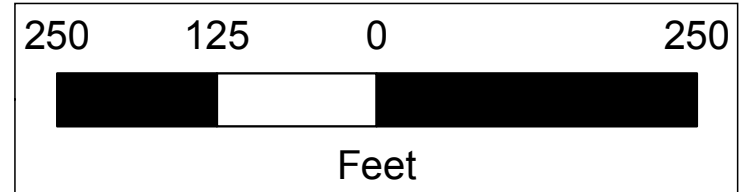

NOTE:
Reference point coordinate pairs and Project Boundary traverse shown in UTM Zone 16N, NAD83 (METERS).

EXHIBIT G SHEET 1 OF 1
 DRESDEN ISLAND DEVELOPMENT
 FERC NO. 1262
 PROJECT BOUNDARY MAP
 NORTHERN ILLINOIS HYDRO, LLC

DRAFT